

Universal Framing Anchor TUNI

The **TECO** Universal Framing Anchor can be bent on site to suit all applications.

For stronger nailed joints and economical secondary connections in timber framing. Framing Anchors are an effective, versatile and economical method of providing strong, mechanical joints. Suitable for timber of minimum 44 x 44 section.

SPECIFICATION

- Pre Galvanised steel to EN 10346 DX51D Z275 or grade 1.4301 austenitic stainless steel to EN 10088-2.

INSTALLATION

- All holes should be nailed using 30 x 3.75 square twist nails or equivalent.
- For stainless steel products use 30 x 3.75 stainless steel annular ring shank nails.
- Always ensure that compatible corrosion resistant fixings are used, i.e. do not use galvanised fixings with stainless steel products or vice versa.

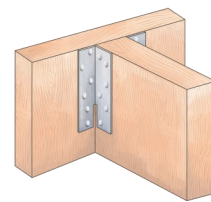
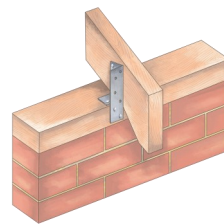
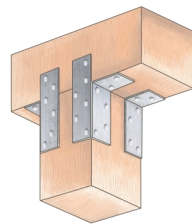
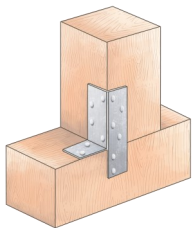

Code	Product	Product Dimensions (mm)		Number of nails (30 x 3.75)	Box Qty.
		Width	Height		
Pre Galvanised - 1mm				Square Twist	
TUNI	Universal Framing Anchor	40 x 40	124	12	100
Stainless Steel - 1mm				Annular Ring	
TSSUNI	Universal Framing Anchor	40 x 40	124	12	-

☎ 01273 423 983 📠 01273 410 074 @ sales@tecoproducts.co.uk

TECO Building Products, Wellington Road, Portslade, Brighton, East Sussex, BN41 1DN

Ron Sammons Ltd. t/a TECO Building Products, Reg no. 1398336

Framing Anchor Du-al-Clips DL & DR

An all purpose framing anchor with dual-grip action for rigidity in lighter timber structures. The Du-al-Clip is an alternative to the **TECO** Trip-L-Grip Framing Anchor where lighter loads and shorter spans permit.

Provides nailing on two surfaces for jointing two timber members, where one member crosses or is trimmed to another (as in the fixing of suspended ceiling, framework to the underside of trusses or beams, or in light studding and joist trimming).

- Hook that can be tacked in position before nailing.
- Each Anchor has two large holes to permit the fixing of a surface covering.



SPECIFICATION

- Pre Galvanised steel to EN 10346 DX51D Z275 or grade 1.4301 austenitic stainless steel to EN 10088-2.
- Only 89mm high, each flange being 44 x 36mm.

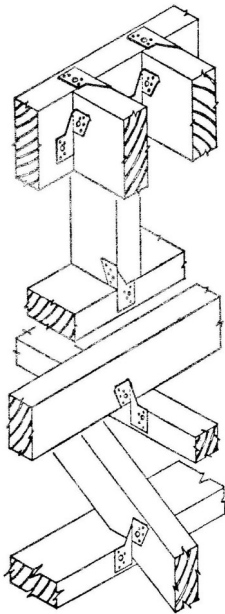

INSTALLATION

- All holes should be nailed using 30 x 3.75 square twist nails or equivalent.

Recommended Safe Working Loads			
Duration of Load	Timber Group	A	D
Long Term Loading (Live & Dead Loads)	J2	(300 lbs.) 1.34kN	(300 lbs.) 1.34kN
	J3	1.07kN (240 lbs.)	1.07kN (240 lbs.)
Short Term Loading (Wind Load)	J2	(400 lbs.) 1.78 kN	(400 lbs.) 1.78kN
	J3	1.43kN (320 lbs.)	1.43kN (320 lbs.)

Code	Product	Product Dimensions (mm)		Number of nails (30 x 3.75)
		Flange	Height	
Pre Galvanised - 1mm				Square Twist
DL	Du-al-Clip Left Hand	36 x 44	89	8
DR	Du-al-Clip Right Hand	36 x 44	89	8